

VILLAGE of HOBART, NEW YORK

MAPS and NOTES

showing

SETTLEMENT and GROWTH

- 1) 1778 - Regional Map - Northern Frontier of NY State
- 2) 1788 - Excerpts from William Cockburn Survey of New Stamford
 - a) from Map, showing "Payne's Mills" area
 - b) from Survey Field Notebook, showing "Painsdale" area
- 3) 1800 - Map by Andrew Beers, of Hobart Village area
- 4) 1820s - Map of Cemetery area, in Hobart Village
- 5) 1856 - Hobart Village (Jay Gould map)
- 6) 1869 - Hobart Village (Beers Atlas map)
- 7) "Main Street" in Hobart - excerpts from insurance maps
 - a) 1891
 - b) 1927
- 8) "Playground" area in Hobart - excerpts from insurance maps
 - a) 1912
 - b) 1927

Compiled by James Meagley

for

Winter Respite Lecture Series
Adams Antiquarian Book Store
February 14, 2010

NOTES re REGIONAL MAP on Page 3

Map and Excerpts from "The Mark of Honour" by Hazel C. Matthews, 1965
[published in Canada, a book about American Loyalists in NY State who moved to Canada]

1768 - Fort Stanwix Treaty - opened lands for settlement; east of the Treaty Line

1771, Spring.....The Harper, Kortright and Banyar patents were opened for settlement, at which time John Harper, Jr. moved his family to Harpersfield [from Cherry Valley]. Whereas Harper drew settlers of the second and third generations of Scotch-Irish Protestants from New England, Lawrence Kortright and Goldsbrow Banyar contact new immigrants at the port of their arrival [in NY City], most of whom were Gaelic-speaking protestants from Scotland and Ireland.

The upper valley of the West Branch [of Delaware River] was known as the Head of the Delaware, and the Kortright and Banyar patents were given the name of Kortright Township. The Harpers called their settlement Harpersfield. ["Head of the Delaware" was a named used for many years to the area around the present day village of Stamford.]

[Many of] the Scots [who were British Loyalists] were all within a radius of six miles as the crow flies from the centre of the settlement. In modern times, this area is roughly bounded by on the north by North Harpersfield, on the south by Bloomville, on the west by Davenport and Fergusonville, on the east by Stamford and Hobart.

LOYALIST SETTLERS in vicinity around Hobart (per references in "The Mark of Honour")

Bennett, Daniel and Obijah	1775, New Stamford, on Town Brook [Township]
Chisholm, George	1773, bought 100 acres, south side of Delaware [near SK village?]
Dingwall, James and John	1775, New Stamford, on Town Brook [Township]
Fraser, James	New Stamford
Fraser, William; son Simon	1775, Delaware River, at Town Brook
More, Alex and John	1774, New Stamford, on Town Brook [Township]
Rose, Hugh	1774, mouth of Roses Brook, at Delaware River
Rose, James	1773, Delaware River (south side), at Roses Brook
Rose, William	1773, mouth of Betty Brook, at Delaware River
Stoneburner, Jacob	1772, 500 acres - on Delaware River, near Town Brook
with Jacob Jr., John, Joseph, Leonard	[last name = Steenbrander??]
Stuart, Dr. James	1774, 400 acres on Delaware River, at Town Brook

ONLY Hugh Rose stayed in the area during the Revolutionary War period
Spring 1777 - many of these loyalists were arrested; many ultimately moved to Canada by 1780s

Northern Frontier 1778

of the Province of New York at opening of Rebellion as taken from Claude Joseph Sauthier's map

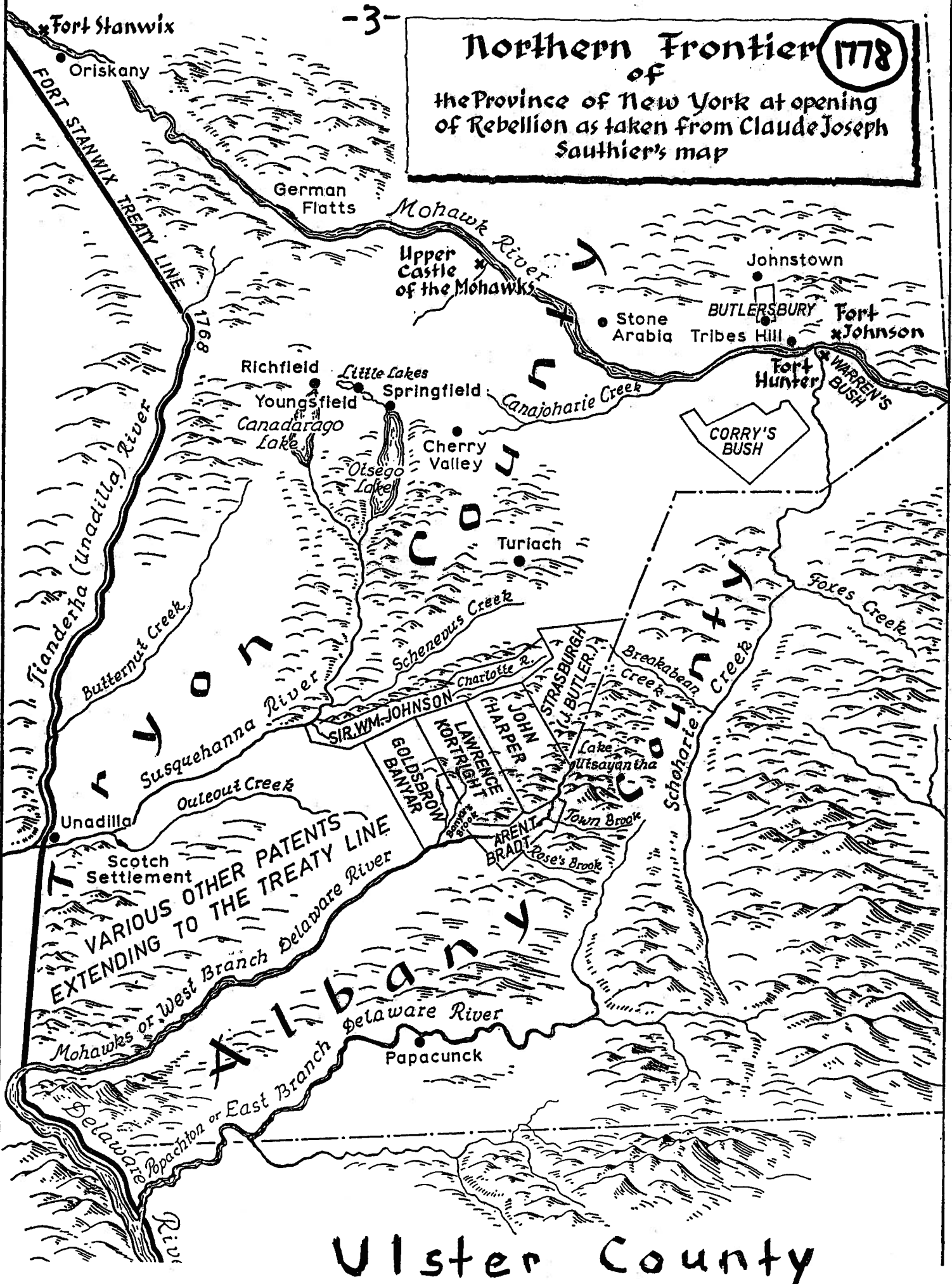

VARIOUS OTHER PATENTS
EXTENDING TO THE TREATY LINE

Ulster County

NOTES re COCKBURN SURVEY Map and Notes on Page 5

BACKGROUND - William Cockburn "re-surveyed" the New Stamford township area, within Lot 42 of Hardenburgh Patent, during summer of 1788 (original survey lines done in 1764-1765 were lost during Revolutionary War period). The West Branch of the Delaware River was a significant boundary line through the Hobart village area. Prior to 1788, settlement in present day area of "Town of Stamford" was sparse - by early 1790s, settlement was increasing significantly.

References to "Painesdale" from "The Mark of Honour" book

[As of about 1804].... Around [Hugh Rose's] mill on Rose's Brook was clustering a community which would be shown on later maps as Roseville [today = South Kortright village area]. Upstream at the falls in the Delaware [River] above the mouth of Town Brook was the settlement spreading out from Paine's grist and sawmill built soon after the war [about 1784-1785?]. In this community known as Paines' Dale [today = Hobart, on the Route 10 side of the river], the first store and inn near "the Mills" were kept by Ezra Paine. ...Paines' Dale on the Delaware became the place of business rather than [the "Town Plot" area in] New Stamford [today = Township area] which remained as it had begun, an agricultural community.

Augustus Bates had gone to New Stamford with the post-war [Revolutionary War] influx of settlers from the coastal townships of Connecticut, and he had settled as a merchant in Paines' Dale, the community which sprang up around the mills constructed at the falls in the Delaware at Town Brook. William [Bates] was in some way connected with the grist mill. [Williams Bates went to Canada in about 1798, and Augustus Bates went by 1800.]

Once very Presbyterian, this settlement [Paines' Dale] was now almost solidly Episcopalian under the leadership of Reverend Ebenezer Dibblee from Stamford, Connecticut. The Bates, particularly Augustus, had been active members of this congregation. [St Peter's Episcopal Church]

In 1787, a road was built from Kortright Centre to the Paines Mills' area, to allow Kortright residents to travel to Painesdale. This road followed a northern section of today's Betty Brook Road and a southern portion of today's McMurdy Brook Road.

Background of Ezra Paine (born 1749 in Connecticut, died in 1803)

Was a soldier in the Revolutionary War. Attracted by reports of valuable ores, he moved to NY State with his brothers in about 1784-1785 and settled near the head of the Delaware River, where he built a flour mill, the first in that region. Per obituary in 1854 of daughter, Abigail, the family moved to NY State in 1784; Abigail married local attorney, Anthony Marvine in about 1792. Ezra constantly looked for mines with valuable ores, and on a prospecting trip toward the west (maybe western NY State?), he died. 1790 census - Harpersfield; 1800 census - can't find?

NOTES re MAP (Circa 1800-1802) on Page 7

FROM HISTORY RECORDS of ST. PETER'S CHURCH

1794 - Episcopal congregation organized on Dec 8, 1794 to cover towns of Stamford, Harpersfield and Kortright; first members - Andrew Beers, Ebenezer Sturgis, Moses Sackrider, Henry Bradford, Stephen Bartow, Truman Beers, Gershom Hanford, Augustus Bates, Elijah Baldwin, William Bates, Perry Sturgis [Sturges], John Perry, James Whitmore [Wetmore].

1800 (summer) - Episcopal Church purchased 56 1/2 acres of land and built rectory house 46 acres, on Harpersfield side of River for \$250 [today, in vicinity of QuickWay gas?] 10 1/2 acres, on Stamford side for \$106 - vicinity of church, playground, toward cemetery in 10 1/2 acre lot, built rectory for \$137.78 ("Glebe House") [today = cemetery] the term "Glebe" was used by Episcopal Church to refer to property owned by the church

1801 (summer) - Episcopal Church re-votes in June on location for church bldg (vote was 46-13) present day location selected over a location near Clove Road, on Township Road Church was built (July - Dec) on the highest knoll in the Village, where the church is today "It ought to be mentioned that this knoll (Beers or Pine Hill) upon which stands the church, was the gift of Andrew Beers, whose name occurs so frequently in the early history of the church."

1802 - Oak tree planted in front of Episcopal Church, by Andrew Beers

1881 in historical address, about streets from Church - "Formerly, there were four streets leading up to the church. One, towards the south was Church street; the next in front, West street; the one towards the bridge, Maiden Lane; and the other East Garden Street. This last street was along the north line of the present rectory lot." [The rectory lot was on "Pine Street", now Maple Avenue]

FROM HISTORY of DELAWARE COUNTY by Munsell (1880)

Andrew Beers built the first grist-mill in Hobart at lower dam

Andrew Beers built the lower dam in 1793 [the online transcription of book incorrect states 1783]

Andrew Beers lived on the corner of River and South [Pearl] Streets, where John Hanford now lives. [See 1869 Map from Beers Atlas, "J Hanford" lives on corner of River and South Streets]

1800 FEDERAL CENSUS - EXCERPTS for HOBART AREA

in Delaware/Harpersfield

John Wilcox [near Whiskey Hollow Rd]

Peter Warren

Joseph Hallet

William Sturges

Bailey Foote [son of George]

George Foote

[Footes in the former
Painesdale area?]

in Delaware/Stamford

Daniel Silliman

Alexander Grant [back road to SK]

on Lot 325 [old Ivan Cole farm??]

William Whitely

Andrew Beers [Hobart?]

John Hall [Hobart?]

Peter Grant [Hobart?]

John Perry [Hobart?]

CIRCA 1800-1802?

GLEBE LOT 46 acres

AREA OF PAINESDALE

NO SAW MILL

4th Street?

GLEBE HOUSE

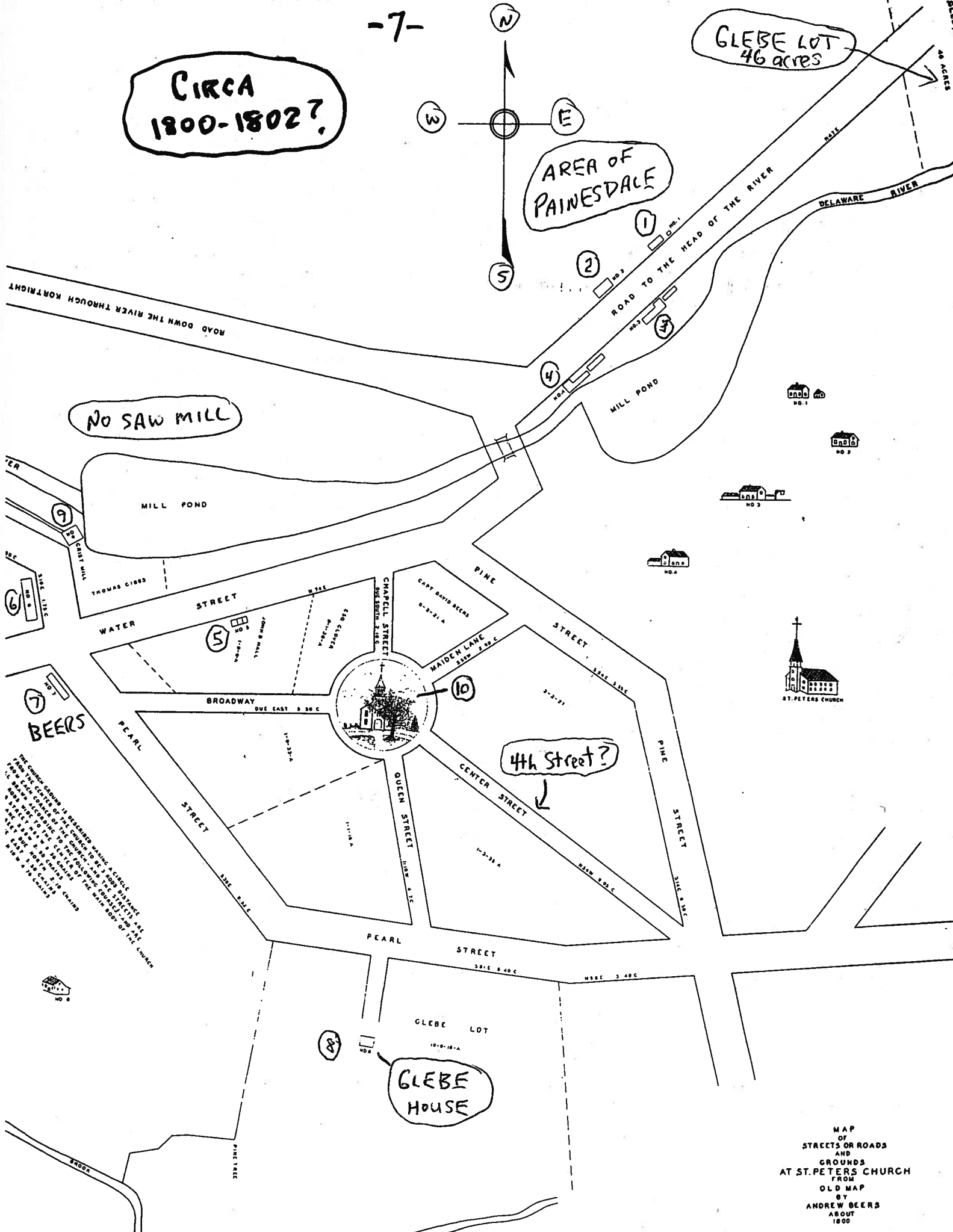

THE CHURCH GROUNDS IS ASSUMED TO BE A CIRCLE
 WITH THE CENTER OF THE CHURCH AS THE CENTER
 AND THE DISTANCE TO THE CENTER OF THE CHURCH
 AS THE RADIUS. THE DISTANCE TO THE CENTER OF
 THE CHURCH IS 100 FEET. THE DISTANCE TO THE
 CENTER OF THE CHURCH IS 100 FEET. THE
 DISTANCE TO THE CENTER OF THE CHURCH IS 100
 FEET. THE DISTANCE TO THE CENTER OF THE
 CHURCH IS 100 FEET. THE DISTANCE TO THE
 CENTER OF THE CHURCH IS 100 FEET.

MAP
 OF
 STREETS OR ROADS
 AND
 GROUNDS
 AT ST. PETERS CHURCH
 FROM
 OLD MAP
 BY
 ANDREW BEERS
 ABOUT
 1800

NOTES re MAP (circa 1816-1832) on Page 9 of cemetery area

GLEBE HOUSE - built in summer of 1800, used until 1832

Per 1881 History of St Peter's Church - "1832, December 26th. It was ordered to purchase of Perry and Wainwright for \$693.37 the house and lot formerly owned by Joseph Beers [son of Andrew Beers], now the present rectory [on Maple Avenue]--also that the Glebe [land] lying in Stamford be sold, reserving a sufficient burying ground which is the knoll on the east side."

JOHN FOOTE (1783-1834) - a son of George Foote (per Foote Genealogy)

Per Munsell History of Delaware County (1880) - John Foote was the first blacksmith . He worked in the trip hammer shop [located on Town Brook], and also made grass scythes.

Per Griffin History of Town of Stamford (1880) - John Foote was a taxpayer in or before 1810 and resided in Hobart and carried on the blacksmith business. He had a shop by the side of the town brook south of the Village where had a trip-hammer which was operated by water power, and manufactured scythes. He resided in Hobart until the time of his death [in 1834, age 50].

Frederick W. Foote (1815-1885) - a son of John Foote; was a banker in Hobart; continued to live in this house; appears on the 1856 Map by Jay Gould and 1869 Map from Beers Atlas.

SCHOOL (from 1881 History of St Peter's Church)

"There was an Academy on the N. W. corner of the present cemetery, erected 1805, a two story edifice--the lower floor used for school purposes under the direction of Mr. Kingsley, the upper used as a Masonic Lodge Room. It was destroyed by fire in 1816, and two years after the land was given to the Church for a cemetery."

FIRST CEMETERY (from 1881 History of St Peter's Church)
[the "burying ground" area noted in this map = Section B today in cemetery]

Listed under "1820" [should this be 1802??] - "Mrs. Sarah Gunn, wife of Andrew Beers, the great astronomer and calendar almanac maker, gave land in the south east part of the Cemetery to the Church, where she was buried as the first interment [April 1803]; this plot together with a portion of the Glebe land forms the present [cemetery] limits. Soon after, George Foote started an opposition cemetery very near the Church; it is about four rods square, enclosed with a stone wall, little used. [first burial in church cemetery - Charity Foote 1817, then husband George 1822].

GROWTH of the CEMETERY

1802 - land donated by Sarah Gunn Beers; 1818 - land from former school given to cemetery
1832 - sale of "Glebe House", land added to cemetery; 1897 - on east side, bought 2 acre parcel in Jan from St. Peter's Church, and bought 1/2 acre parcel in Oct from CC Champlin; April 1911 - on west side, bought 4 acre parcel from McNaught family.

HOBART

1869

11

Stamford Township
Scale 30 Rods to the Inch.

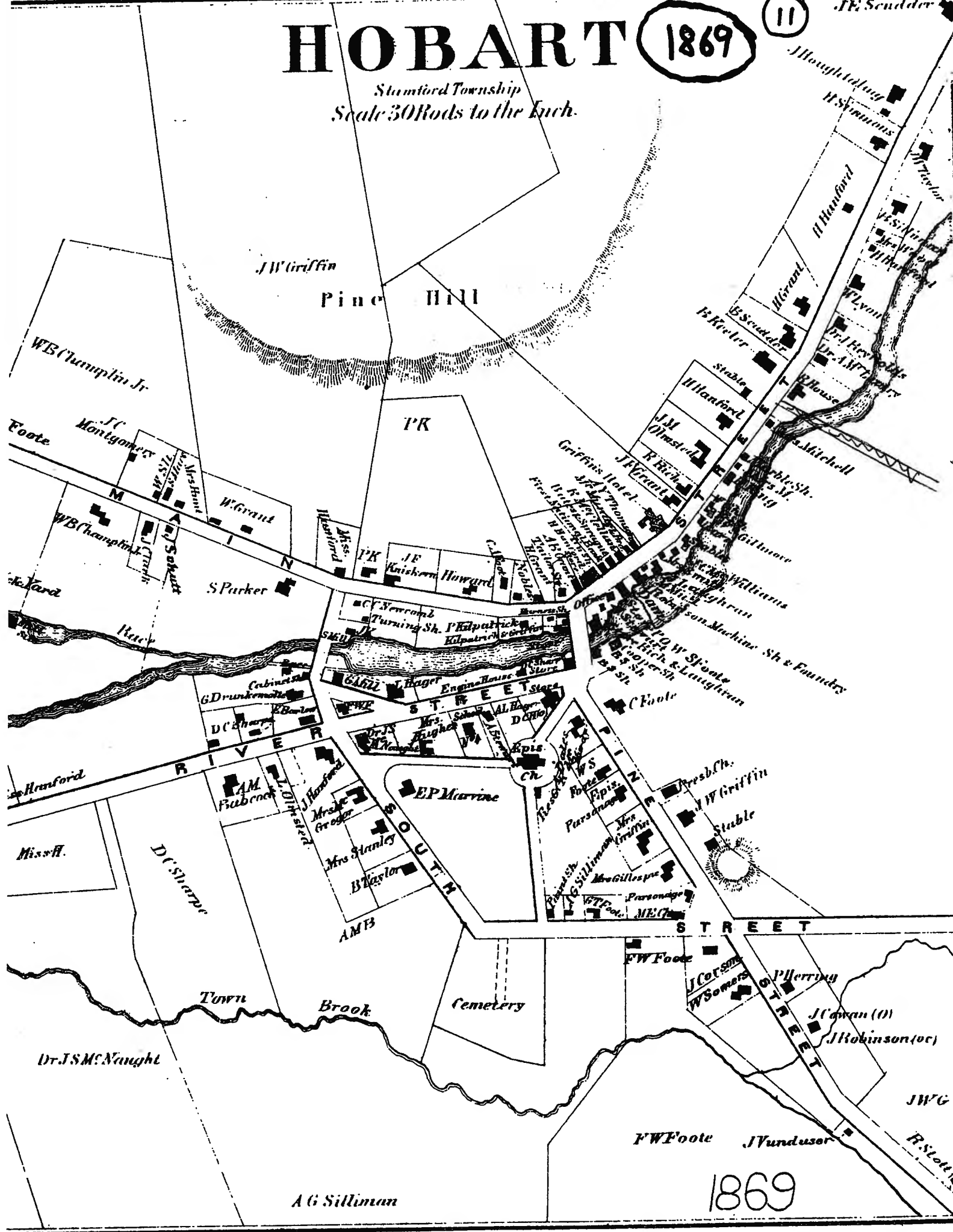

A.G. Silliman

1869

J.W.G.

F.W. Foote

J.V. Dundas

R. Slatis

J.Cavan (D)
J. Robinson (or)

J. Corson
W. Somers

F.W. Foote

STREET

SOUTH STREET

Cemetery

Town Brook

Dr. J.S.M. Naught

Miss H.

D.C. Sharp

Mrs. Stanley
B. Taylor

Mrs. Groves

Mrs. Griffin

EP Marvin

Epis

Pers. Adams

Mrs. Griffin

Stable

J.W. Griffin

C. Foote

W. Spinks
& Laughlin

W. Spinks

W. Spinks

W. Spinks

W. Spinks

W. Spinks

W. Spinks

W. Spinks

W. Spinks

W. Spinks

W. Spinks

W. Spinks

W. Spinks

W. Spinks

W. Spinks

W. Spinks

W. Spinks

W. Spinks

W. Spinks

W. Spinks

W. Spinks

W. Spinks

W. Spinks

W. Spinks

W. Spinks

W. Spinks

W. Spinks

W. Spinks

W. Spinks

W. Spinks

W. Spinks

W. Spinks

W. Spinks

W. Spinks

W. Spinks

W. Spinks

W. Spinks

W. Spinks

W. Spinks

W. Spinks

W. Spinks

W. Spinks

W. Spinks

W. Spinks

W. Spinks

W. Spinks

W. Spinks

W. Spinks

W. Spinks

W. Spinks

W. Spinks

W. Spinks

W. Spinks

W. Spinks

W. Spinks

W. Spinks

W. Spinks

W. Spinks

W. Spinks

W. Spinks

W. Spinks

W. Spinks

W. Spinks

W. Spinks

W. Spinks

W. Spinks

W. Spinks

W. Spinks

W. Spinks

W. Spinks

W. Spinks

W. Spinks

W. Spinks

W. Spinks

W. Spinks

W. Spinks

W. Spinks

PAGES 12 -14

Involved excerpts from Sanborn insurance maps

which are subject to copyright protection

we hope to provide copies of these materials

if approval can be obtained from copyright holder

THIS SUBJECT MATTER covered the discussion for topics

- 7) "Main Street" in Hobart - excerpts from Sanborn maps
 - a) 1891
 - b) 1927
- 8) "Playground" area in Hobart - excerpts from Sanborn maps
 - a) 1912
 - b) 1927